

SITE SKETCH

LOT #20 BLOCK B

MATHEWS SUBDIVISION

ANY COUNTY, VIRGINIA

SITE SKETCH DRAWN TO SCALE FROM A DIGITAL FILE BY ACME SURVEYING DATED SEPTEMBER 7, 2005.

DRAINFIELD MUST BE INSTALLED ON GRADE.

WELLS OR SEPTIC FIELDS OBSERVED WITHIN 200' OF THE PROPOSED DRAINFIELD ARE SHOWN ON HOMESITE PLANNING MAP.

NOTE: THE BACK-FLUSH FLUIDS FROM WATER TREATMENT UNITS SHALL NOT BE DISCHARGED INTO HOUSEHOLD PLUMBING. ALL WARRANTIES EITHER WRITTEN OR IMPLIED ARE NULL AND VOID IF WATER TREATMENT FLUIDS ARE DISCHARGED INTO SEWERS LEADING TO THE DRAINFIELD OR SEWAGE TREATMENT COMPONENTS.

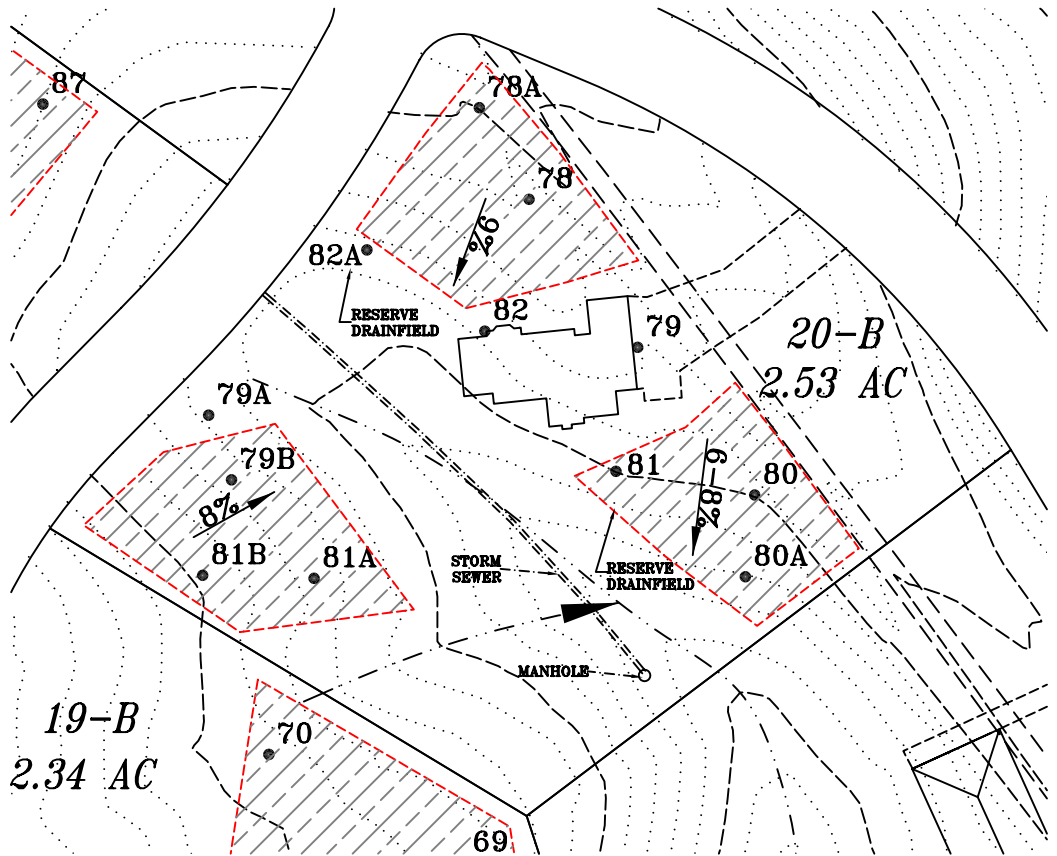

LEGEND

- SOIL BORE # & LOCATION
- DOCUMENTED SOIL AREA
- TOPO
- GULLY
- NATURAL DRAINAGE SWALE
- PROPOSED HOUSESITE
- PROPOSED DRIVEWAY
- PROPOSED WELL SITE

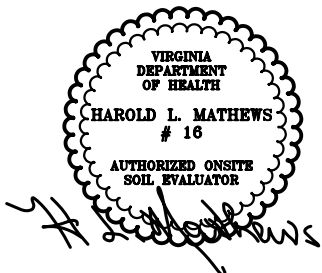

MARCH 16, 2007
 JOB NUMBER: 9999
 FILE: WEB DESIGN

MATHEWS SOIL CONSULTANTS INC.
 5700-C HOPKINS ROAD
 POST OFFICE BOX 34099
 RICHMOND, VIRGINIA 23234
 EMAIL: MSCINC@CAVTEL.NET
 PHONE: 804-271-0136
 FAX: 804-271-7148